



Philips OnSite AED

Initial Setup



1

Remove Philips Onsite from Box



2

Open Case and Pull Green Tab

- This will install the battery* and start the self-test.

**Please keep in mind the battery may be shipped in a separate box due to shipping regulations.*

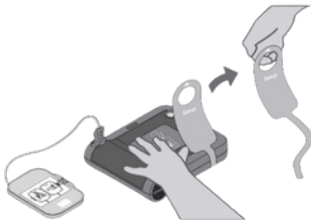

3

Follow Self-Test Voice Prompts

- Follow the prompts (i.e. press the orange shock button when flashing)



4



Note Battery Install Date

- On the AED battery sticker
 - Month and year the battery was installed
 - Month and year 4 years from installed date
- On inspection tag

*Important: the "Install by" date on the battery is NOT an expiration date. It is a warranty date where if installed before that date it will last 4 years.

5



Check for Green Blinking Light

- **Green** blinking light means your AED is ready for use.
- You can see the blinking light through the clear opening in the standard carry case.
- The Onsite battery has a 4-year warranty from the date is installation.
- The Onsite pads will need to be replaced every 24 months, please monitor the expiration dates.

Important: The AED must be inspected monthly to ensure it is ready for use at all times. Monthly inspections include checking that the green light is blinking and the AED is not beeping.

Additional Reference Videos



ANY QUESTIONS? CONTACT US

Hawaii Office

📞 808-440-8988

✉ info@aed808.com

West Coast Office

📞 949-990-8055

✉ WestCoast@aed808.com



www.aedinstitute.com